

**Steel guide track for cantilever gate**

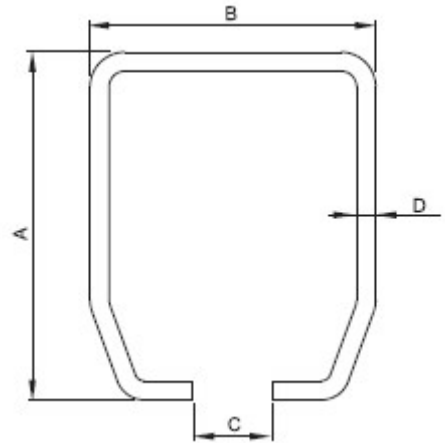

**Technical features:**

This guide track is roll formed using 3mt or 6mt galvanized DX51DZ275 (EN 10327-04 EN 10143-93) steel bars

**Dimensions:**

Art.	A (mm)	B (mm)	C (mm)	D (mm)	length	finishing	Load capacity (kg)**	weight (kg/mt)	Packg	Pack
857/1.3.76	60	65	18	3,5	3mt	galvanized	350	5.520	1	30
857/1.6.76	60	65	18	3,5	6mt	galvanized	350	5.520	1	30
857/2.3.76	75	80	22	4,5	3mt	galvanized	600	8.610	1	15
857/2.6.76	75	80	22	4,5	6mt	galvanized	600	8.610	1	15
857/3.3.76	110	90	25	6	3mt	galvanized	1200	15.210	1	10
857/3.6.76	110	90	25	6	6mt	galvanized	1200	15.210	1	10

**\*\*Load capacity refers to the chart table of Catalogo Sistemi (see chart pages 18-21)**

The quality management system of NOVA-FERR srl complies with the requirements of the standard for quality management systems.



## **Description:**

This guide track rail is suited for self standing cantilever gates and is to be welded directly onto the gate to be rolled on floor carriages, as an alternative to the traditional floor track rail.

---

*The quality management system of NOVA-FERR srl complies with the requirements of the standard for quality management systems.*



**NOVA-FERR S.r.l.**  
Accessori per serramenti e  
portoni industriali

[www.novaferr.com](http://www.novaferr.com)

La garanzia del  
**PRODOTTO** made in **ITALY**

